

fischer DUOPOWER

The Duo of power and intelligence.

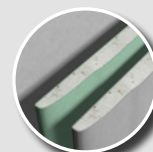

fischer DUOPOWER.

Simply clever, the combination of 2 components for 3 functions.

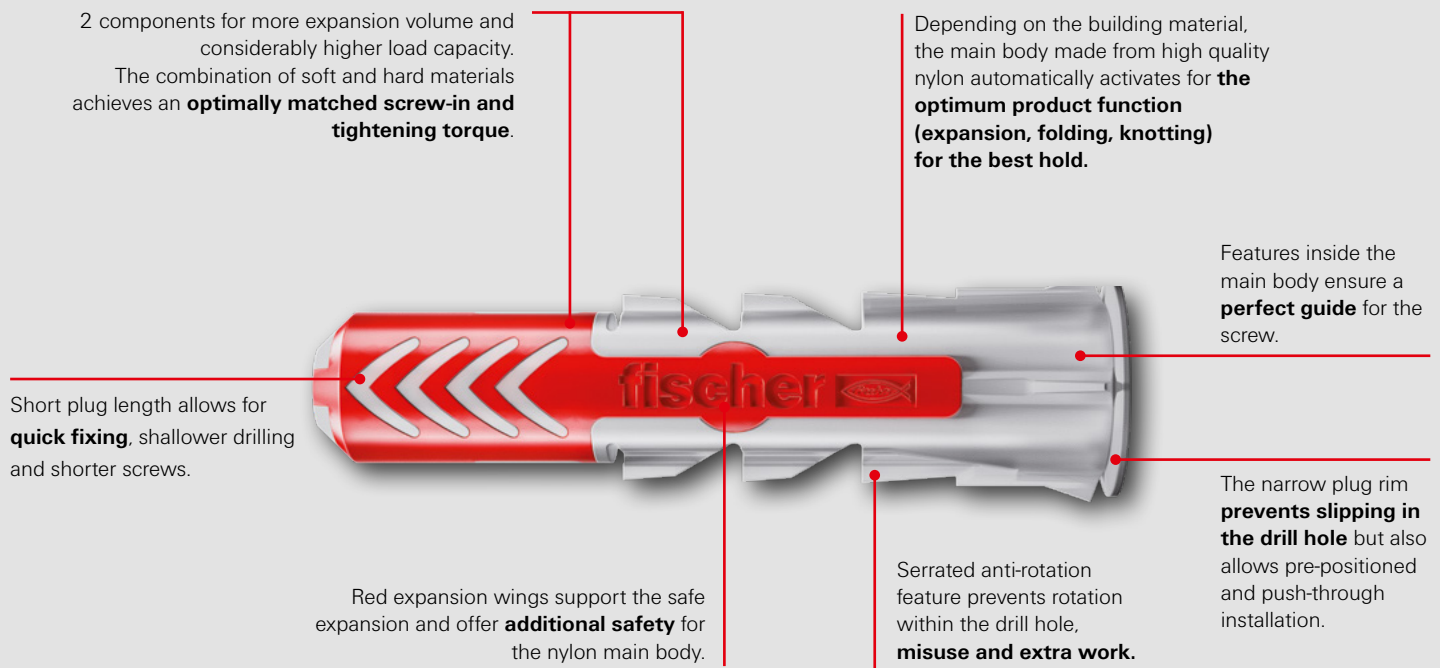

Function.

- The duo of 2-component material ensures high material displacement, thereby facilitating higher loads. Depending on the building material, the plug activates the optimum product function (expansion, folding, knotting) for the best hold.
- The DUOPOWER is suitable for pre-positioned and push-through installation.
- Suitable for sheet metal, wood, chipboard and LAG screws. Screw length = plug length + fixture thickness + 1x screw diameter.
- In the case of board building materials, the threadless part of the screw must not be longer than the fixture.

Your benefits at a glance:

- Two component materials for the best load values in solid and hollow building materials and intelligent, self-activating functions (expansion, folding, knotting) depending on the substrate. For a wide range of applications.
- Best possible feedback (feelgood factor) from the plug. You can feel when the plug is installed perfectly.
- The short and compact plug shape reduces drilling work and saves material and time.
- The narrow plug rim ensures a problem-free installation but facilitates a broad application, whether pre-positioned or push-through installation.
- No annoying plug rotation during installation, thanks to the serrated anti-rotation feature.
- The smooth-running opening allows the simple positioning of the screw and the secure guiding and fixing in the screw channel.

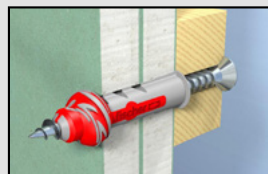
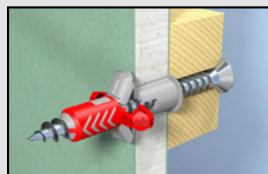

fischer DUOPOWER.

For the simplest and safe installation into innumerable building materials.

Installation in solid building materials

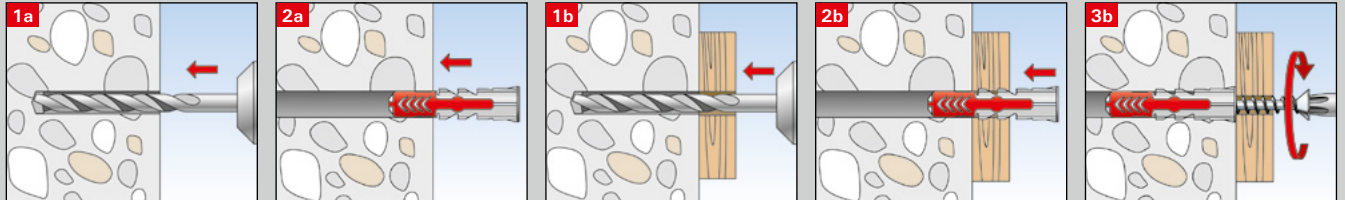

Installation in hollow building materials

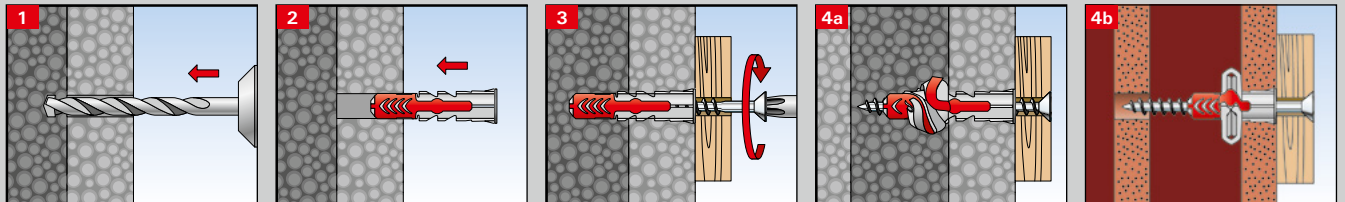

Installation in board building materials

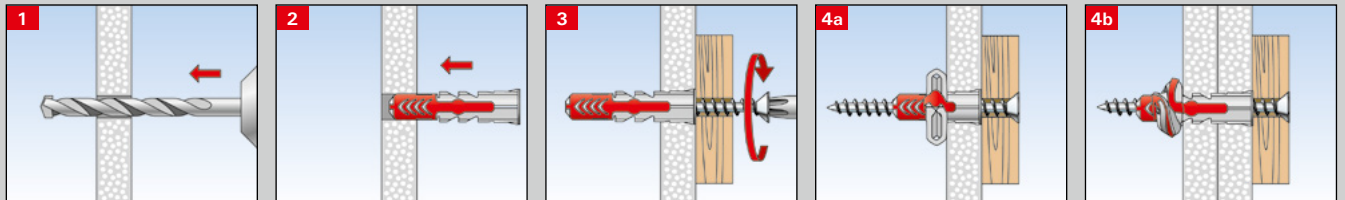

Test mark



Recommendation



- Suitable for: concrete, solid brick, solid sand-lime brick, aircrete, vertically perforated brick, perforated sand-lime brick, plasterboard, gypsum plasterboard and gypsum fibreboard, hollow block made from lightweight concrete, cavity floor slabs made from brick, prestressed hollow-core concrete floor slab and similar, natural stone, chipboard, gypsum boards, lightweight concrete solid brick,

Applications.

TV wall bracket



Cable system lights



Pictures



Shower cubicles



Wall cupboards



Window blinds



Handrails



Wall cabinets



Assortment and loads.

	without screw	with screw	Drill bit - nominal-ø	min. drill hole depth	anchorage depth	Plug length	Sheet Metal Screw	max. fixture thickness	min. screw depth	Available screw size	Drive	Sales unit
Item description	Item no.	Item no.	d ₀ [inch]	h ₁ [inch]	h _{ef} [inch]	l [inch]	d _s / d _s x l _s [size x inch]	t _{fix} [inch]	lE _{min} [inch]			Units
DUOPOWER 3/16"	548571		3/16	1 3/8	1	1	-	-		4 - 6	-	100
DUOPOWER 1/4"	548572		1/4	1 5/8	1 3/16	1 3/16	-	-		6 - 10	-	100
DUOPOWER 5/16"	548573		5/16	2	1 5/8	1 5/8	-	-		8 - 12	-	100

DUOPOWER INCH

Allowable Capacities^{1),2)} for a single anchor.

Type			3/16"		DUOPOWER 1/4"		5/16"	
Sheet Metal Screw			4 - 6		6 - 10		8 - 12	
Recommended loads in the respective base material F _{rec}			Tension ³⁾	Shear ⁴⁾	Tension ³⁾	Shear ⁴⁾	Tension ³⁾	Shear ⁴⁾
Gypsum plasterboard	1/2"	[lbs]	25	35	30	45	35	55
Concrete Hollow Block		[lbs]	35	115	55	200	60	270
Solid Concrete ⁵⁾		[lbs]	50	115	100	200	115	325

¹⁾ Allowable load capacities listed are calculated using an applied safety factor of 4.0.

²⁾ The loads are based on the largest possible screw diameter.

³⁾ The load data are valid for tension and combined tension and shear load.

⁴⁾ The load data are valid only for shear load.

⁵⁾ Solid concrete compression strength f_c ≥ 4000 psi.

fischer FIXPERIENCE

The design and information software suite



- The modular design program includes engineering software and application modules.
- The software is based on international design standards (ETAG 001, EC1, EC2, EC3 and EC5), including the national application documents. All common force and measurement units are available.
- Incorrect input will be recognized and the software gives tips to get a correct result. This ensures a safe and reliable design every time.
- The graphical display can easily be rotated through 360°, panned, tilted or zoomed as required.
- The 3D display gives a detailed and realistic image.
- The "live update" feature helps to keep the program up to date ensuring you are always working with the latest version.
- Free download and updates at www.fischer.de/fixperience-en

Our service to you



We are available to you at any time as a reliable partner to offer technical support and advice:

- Our products range from chemical resin systems to steel anchors through to nylon anchors.
- Competence and innovation through own research, development and production.
- Global presence and active sales service in over 100 countries.
- Qualified technical consulting for economical and compliant fastening solutions. Also on-site at the construction site if requested.
- Training sessions, some with accreditation, at your premises or at the fischer academy.
- Design and construction software for demanding applications.

This is what fischer stands for



FIXING SYSTEMS



AUTOMOTIVE SYSTEMS



FISCHERTECHNIK



CONSULTING



LNT AUTOMATION

For more information visit our website www.fischer-us.com

fischer fixings LLC
1084 Doris Road
48326 Auburn Hills, Michigan
USA
Tel. +1 248 795 3600
Fax +1 248 276 1941
sales@fischerus.net
www.fischer-us.com

fischer 
innovative solutions