

Your dealer:

www.fischer-international.com



fischer stands for

Fixing Systems
Automotive
fischertechnik
Consulting
LNT Automation

fischerwerke GmbH & Co. KG
Klaus-Fischer-Straße 1 · 72178 Waldachtal
Germany
T +49 7443 12-0 · F +49 7443 12-4222
www.fischer.de · info@fischer.de

fischer fixings UK Ltd.
Whitely Road · Oxon OX10 9AT Wallingford
Great Britain
T +44 1491 827900 · F +44 1491 827953
www.fischer.co.uk · info@fischer.co.uk

FCFcl Cavity Clad.
Effective & efficient fire
stopping seal for the
building envelope.



Product details

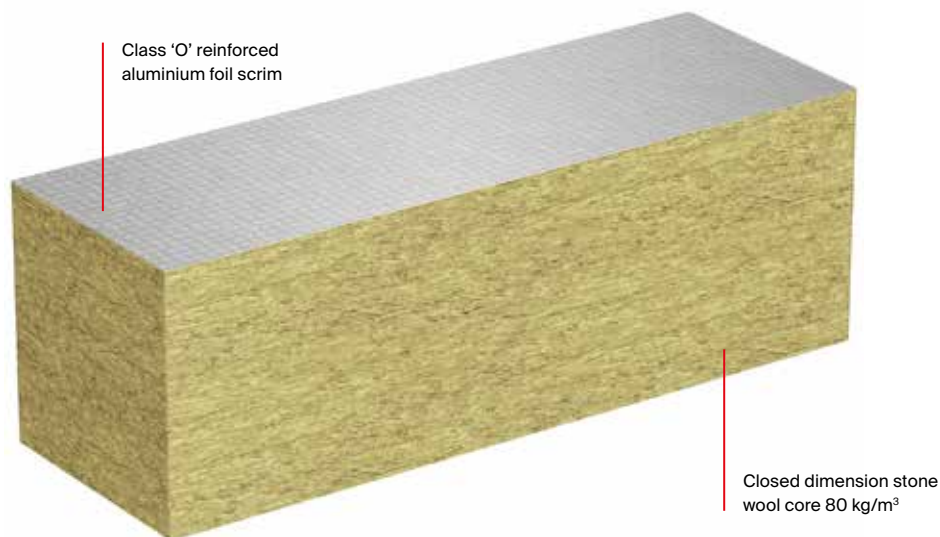

Functionality

- FCFcl Cavity Clad comprises of a 80 kg/m³ one piece closed dimension stone wool core. The product is encased with an aluminum foil face which provides class 'O' rating and exhibits excellent resistance to smoke.
- The FCFcl Cavity Clad provides a resilient lateral compression which is required to ensure a tight fit. Tested BS 476 & EN 1366-4 the FCFcl has been classified to EN 13501-1 and bears the CE mark.

Your advantages at a glance

- GWP of 0% Global Warming Potential.
- ODP of 0% Ozone Depletion Potential.
- Encased fibre migration for air plenum use.
- Life expectancy of over 30 years.
- Contributes to green building.
- Floor & wall voids up to 500mm wide.

Tools, equipment, health and safety



Tape measure



Pencil



Straight edge



Pad saw



Safety boots



Reflective vest



Protection goggles



Head protection



Safety gloves

Installation details

Note installation instructions: Firestop material must be installed in accordance with detailed instruction or the approved system.

Preparation

- Enable access or suitable working platform.
- Ensure that all surfaces are free from loose debris and contaminants.
- Mark positioning of barrier on structure according to the building design.

Storage & disposal

- FCFcl Cavity Clad is not affected by an outdoor environment.
- However, for long term storage and ease of installation it is recommended that it should be stored in dry conditions.
- For a copy of the health and safety details refer to fischer MSDS sheet.

FCFcl installation in curtain wall (horizontal)

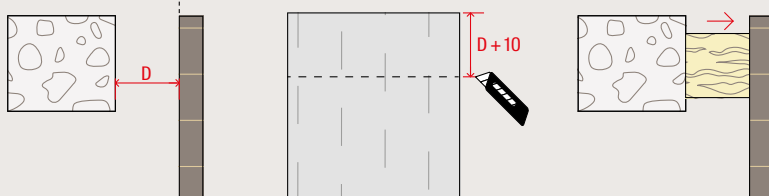

FCFcl installation in rainscreen (vertical)

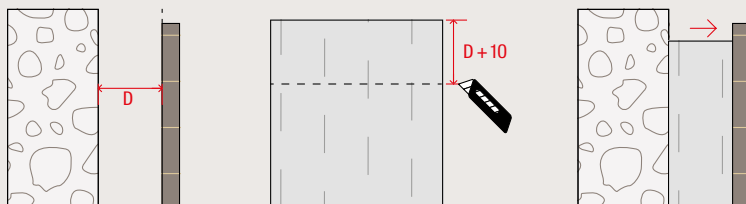

Seal all joints on foil side with appropriate aluminium tape.

Installation Instructions - Solid structure & light weight framing system application:

1. Position the fischer Multi-Purpose Bracket in required location and using an suitable anchor, attach firmly to substrate.
2. Impale the fischer FCFcl Cavity Clad on to Multi-Purpose Bracket at mid height.
3. FCFcl Cavity Clad should not penetrate through complete barrier.

Note: The FCFcl Cavity Clad shall be installed with a Min. 10mm compression. The FCFcl Cavity Clad shall be impaled onto the fischer Multi-Purpose Bracket but shall only penetrate barrier 2/3 of the way through.

Certificates



British Standard
BS 476 - 20

BS EN1366-4: 2006

BS EN ISO 10140-3 : 1995

BS EN 1026



APPROVED
PRODUCTCF5659